



Digital Platforms Pvt. Ltd.

A Subsidiary of CWD Limited

ADVANCED DIGITAL REPEATER

CWD CD885

ENHANCE YOUR OPERATION



ENHANCED VERSION HIGHLIGHTS

Outstanding Performance

Enhanced CD885 includes a high-performance chipset, featuring delivering fast processing for demanding applications.

High Integration

Integrated router and SIP gateway simplify system management and reduce infrastructure cost, especially for network construction.

Convenient Management

A web-based backend management platform allows easy device configuration and operation, ideal for remote control and monitoring.

High Security

SNMP v3 technology enhances communication security, ensuring data is protected in complex scenarios.

Flexible Interconnection :-

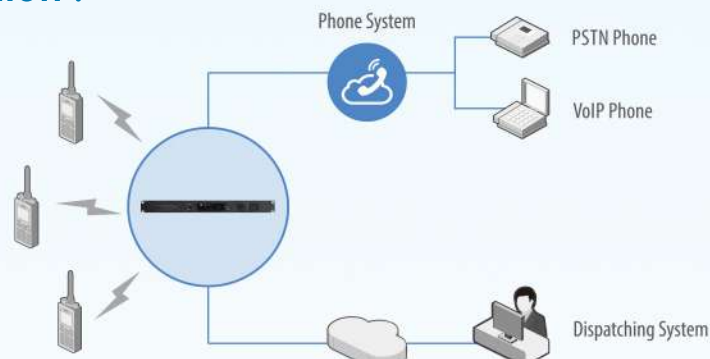

Wireless Link Communication :-

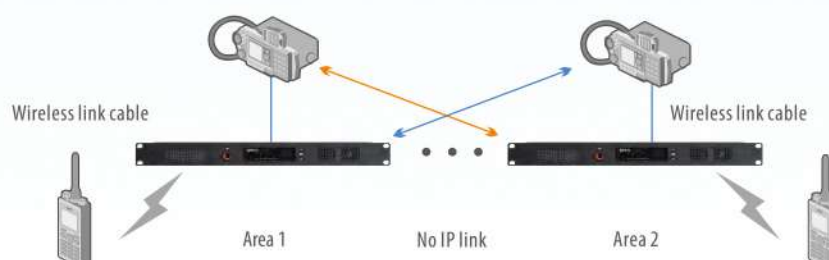

Empower Your Operation

Organizations today face growing challenges across sectors like public safety, utilities, and industry. To enhance safety and operational efficiency, reliable and instant communication is vital. The CD885 series repeater, a next-generation digital solution from CWD, ensures seamless voice and data communication with wide coverage and high-performance network reliability.

HIGHLIGHTS

GENERAL HIGHLIGHTS

Economical UI Structure

Compact and lightweight design makes CWD CD885 ideal for easy installation.

AC/DC Auto Switch

Supports both AC and DC inputs with automatic switching for versatile power compatibility.

Wide Coverage

Enhanced communication range enables flexible deployment, allowing CWD CD885 to connect to various systems effectively.

Analog & Digital Auto Switch

Supports mixed analog and digital channels, enabling seamless switching and transition for improved performance.



Connectivity to more applications

SPECIFICATIONS

General	
Frequency Range	UHF: 400-470MHz VHF: 136-174MHz
Channel Capacity	64
Channel Spacing	12.5KHz/ 20KHz/ 25KHz
Operating Voltage	DC: 13.6V±15% AC: 100-240V
Current Consumption(DC)	Standby: ≤0.9A Transmitting: ≤12A
Current Consumption(AC)	Standby: ≤0.35A Transmitting: ≤1.2A
Frequency Stability	±0.5ppm
Antenna Impedance	50Ω
Duty Cycle	100%
Dimensions(H×W×D)	44×483×366 mm
Weight	5.8kg
Networking	Conventional Mode *Digital Trunking Lite; *Simulcast

*marked features are coming soon.

Receiver		
Sensitivity	Analog	0.18μV(12dB SINAD) 0.16μV(Typical)(12dB SINAD)
	Digital	0.18μV/BER5%
Selectivity	TIA-603	65dB@12.5kHz / 75dB@20/25kHz
	ETSI	60dB@12.5kHz / 70dB@20/25kHz
Inter-Modulation	TIA-603	75dB@12.5/20/25kHz
	ETSI	70dB@12.5/20/25kHz
Spurious Response Rejection	TIA-603	80dB@12.5/20/25kHz
	ETSI	80dB@12.5/20/25kHz
Blocking	90dB	
Hum and Noise	40dB@12.5kHz; 43dB@20kHz, 45dB@25kHz	
Conducted Spurious Emission	≤1GHz	≤-57dBm
	>1GHz	≤-47dBm

Transmitter			
RF Power Output	5-50W(adjustable)		
FM Modulation	11K0F3E @12.5kHz; 14K0F3E @ 20kHz; 16K0F3E @ 25kHz		
4FSK Digital Modulation	12.5kHz Data Only: 7K60FXD 12.5kHz Data and Voice: 7K60FXW		
Conducted/ Radiated Emission	Operating	≤1GHz	-36dBm
		>1GHz	-30dBm
	Standby	≤1GHz	-57dBm
		>1GHz	-47dBm
Modulation Limiting	±2.5kHz @ 12.5kHz; ±4.0kHz @ 20kHz; ±5.0kHz @ 25kHz		
FM Hum & Noise	40dB @ 12.5kHz; 43dB @ 20kHz 45dB @ 25kHz		
Adjacent Channel Power	60dB @ 12.5kHz; 70dB @ 20/25kHz		
Audio Response	+1~ -3dB		
Audio Distortion	≤3%		
Digital Vocoder Type	AMBE+2™		
Digital Protocol	ETSI-TS102 361-1,-2,-3		

Environmental Specifications	
Operating Temperature	-30°C~+60°C
Storage Temperature	-40°C~+85°C

All Specifications are tested according to applicable standards, and subject to change without notice due to continuous development.

ACCESSORIES

Standard



Optional



CWD LTD.

Office no. 14TH FLOOR, UNIT 1406 - 1409, RUPA SOLITAIRE, MILLENIUM BUSINESS PARK, MAHAPENAVI MUMBAI - 400710

✉ info@cwдин.com

🌐 <https://www.cwдин.com/>